

CTU07-37 Series

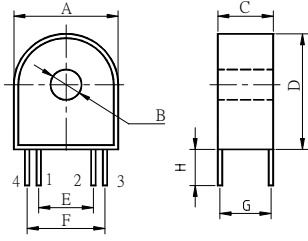

Test Circuit

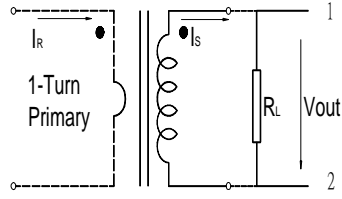

Electrical Characteristic										Mechanical Dimension							
Part No.	IR (A)	Vout (V)	Acc.Class (%)	Imin (A)	Imax (A)	RL (Ω)	f (%)	δ (°)	DCR (Ω)	A(max)	B(max)	C(max)	D(max)	E(max)	F(max)	G(max)	H(±1)
										mm / inch							
CTU07-37-200-21N	0.01~20	2.001	0.5	0.01	40	100	-0.170	7.5	35	37.65 1.48	13.0 0.51	14.3 0.56	39.05 1.54	25.5 1.00	33.0 1.30	13.2 0.52	6.0 0.24
CTU07-37-250-11N	0.01~25	2.4962	0.5	0.01	50	100	0.064	3.6	35								
CTU07-37-300-31N	0.1~30	2.993	1	0.1	65	100	-0.586	5.4	14								
CTU07-37-300-21P	0.015~30	2.012	0.2	0.015	70	100	-0.225	5.0	56								
CTU07-37-300-11P	0.03~30	1.9983	0.2	0.03	100	100	-0.025	2.7	56								
CTU07-37-500-21P	0.02~50	2.504	0.2	0.02	100	100	-0.104	4.0	114								
CTU07-37-500-22P	0.05~50	2.008	0.1	0.05	145	100	-0.020	2.5	142								
CTU07-37-600-11P	0.05~60	2.998	0.2	0.05	120	100	0.013	2.4	114								
CTU07-37-600-31N	0.2~60	2.99	0.5	0.2	175	100	-0.466	19.7	102								
CTU07-37-750-11P	0.1~75	2.996	0.1	0.1	150	100	-0.010	1.6	142								
CTU07-37-750-31N	0.15~75	4.961	1	0.15	200	100	-0.784	29.4	57								
CTU07-37-201-31N	0.15~200	8.008	0.5	0.15	435	100	-0.270	10.1	150								

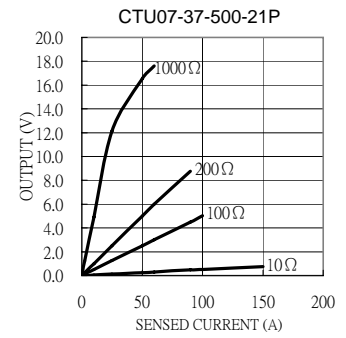
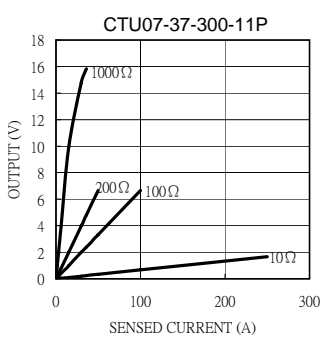
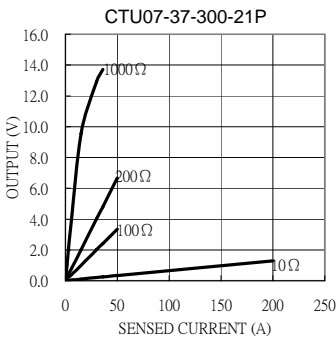
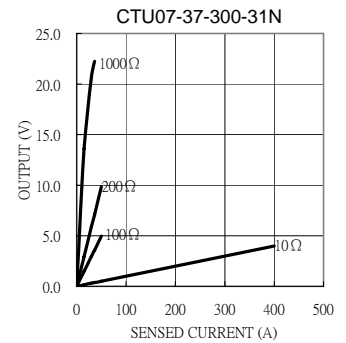
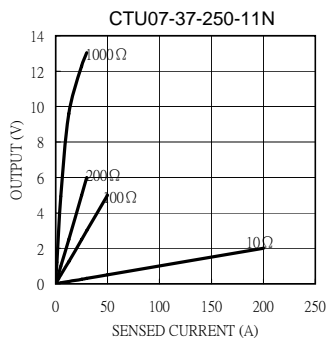
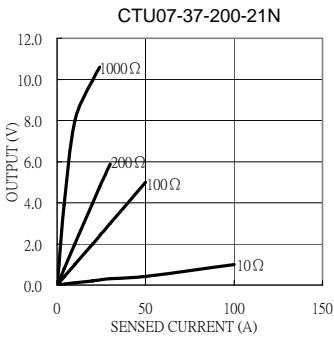

CTU07-37 Series

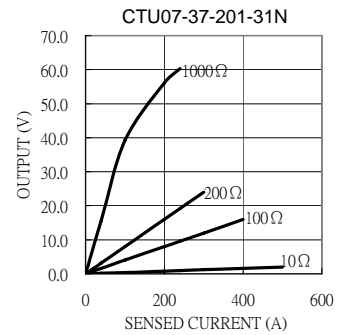
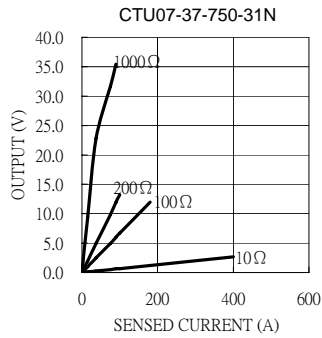
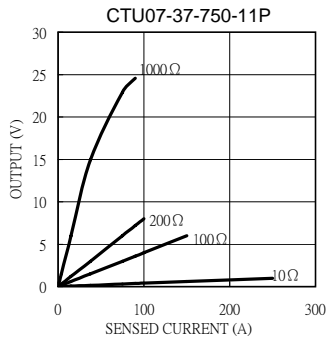
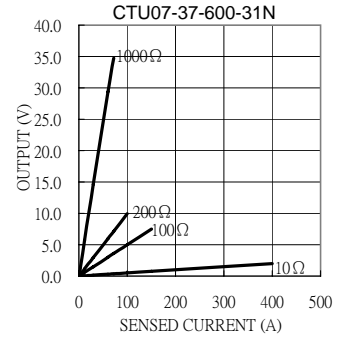
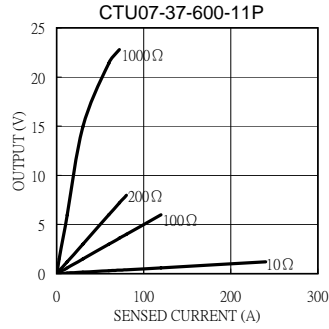
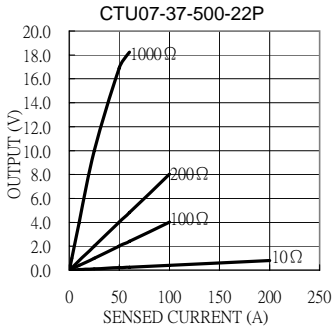

Definition:

I_R : Rated Current

V_{out} : Output voltage.

Acc.Class: Accuracy class.

I_{min} : Min. detecting current which remains linearity.

I_{max} : Max. detecting current which remains linearity.

R_L : Load resistance.

$f(\%)$: Ratio error.

$\delta(\text{'})$: Phase shift.

DCR: Secondary Winding DC Resistance.

Remark:

1. Frequency band :50Hz~60Hz.
2. Operating temperature: $-25^{\circ}\text{C} \sim 80^{\circ}\text{C}$.
3. All current ,voltage refer to rms value.
4. RoHS compliant.
5. Hi-Pot: $2500V_{RMS}/1\text{min}$ between windings.
6. Formula of 2nd output : $V_{out}=I_R * R_L / N(\text{Turns})$.
7. Product parts meet UL requirements.